

BLC

Diamond Series



Stainless Steel, Water resistant Beam Load Cells from Totalcomp

Stainless Steel Construction

Available with Threaded and Counterbored Load Hole

Low Profile

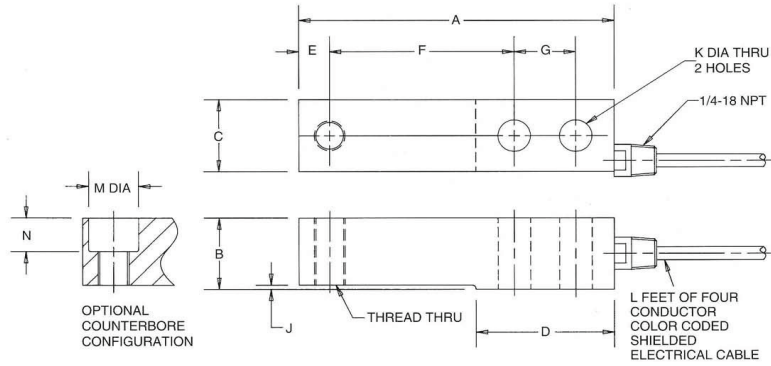

CABLE COLOR CODE

+ EXC	GREEN
- EXC	BLACK
+ SIG	WHITE
- SIG	RED
SHIELD	YELLOW

BLC Diamond Series Load Cells

Matched outputs. Nameplate on cell shows 1.5 mv/v at half capacity. 3 mv/v, 0.02% nonlinearity, 1000/1000 ohm, 17-4 stainless steel. 10 ft 4 cond cable - 500 lb, 1K, 2.5K, 4K ; 20 ft 4 cond cable - 5K, 10K.

Part Number	Capacity	Weight	A	B	C	D	E	F	G	J	K	L	M	N	THREAD SIZE
Threaded load hole															
BLC-250-10716	250 lb	2 lb	5.25	1.19	1.21	2.27	.605	3.00	1.00	.07	.52	10	.81		1/2-20 UNF-2B
BLC-500-10125	500 lb	2 lb	5.25	1.19	1.21	2.27	.605	3.00	1.00	.07	.52	10	.81		1/2-20 UNF-2B
BLC-500-10531 (1K)	1,000 lb	3 lb	5.25	1.19	1.21	2.27	.605	3.00	1.00	.07	.52	10	.81		1/2-20 UNF-2B
BLC-1.25K-10531 (2.5K)	2,500 lb	3 lb	5.25	1.19	1.21	2.27	.605	3.00	1.00	.07	.52	10	.81		1/2-20 UNF-2B
BLC-2K-10531 (4K)	4,000 lb	3 lb	5.25	1.19	1.21	2.27	.605	3.00	1.00	.07	.52	10	.81		1/2-20 UNF-2B
BLC-2.5K-20531 (5K)	5,000 lb	4 lb	6.75	1.44	1.45	3.00	.75	3.75	1.50	.10	.78	20	1.19		3/4-16 UNF-2B
BLC-5K-20531 (10K)	10,000 lb	5 lb	6.75	1.94	1.69	3.00	.75	3.75	1.50	.35	.78	20	1.19		3/4-16 UNF-2B
Counterbored & threaded load hole															
BLC-500-10225	500 lb	2 lb	5.25	1.19	1.21	2.27	.605	3.00	1.00	.07	.52	10	.81	.56	1/2-20 UNF-2B
BLC-500-10631 (1K)	1,000 lb	3 lb	5.25	1.19	1.21	2.27	.605	3.00	1.00	.07	.52	10	.81	.56	1/2-20 UNF-2B
BLC-1.25K-10631 (2.5K)	2,500 lb	3 lb	5.25	1.19	1.21	2.27	.605	3.00	1.00	.07	.52	10	.81	.56	1/2-20 UNF-2B
BLC-2K-10631 (4K)	4,000 lb	3 lb	5.25	1.19	1.21	2.27	.605	3.00	1.00	.07	.52	10	.81	.56	1/2-20 UNF-2B
BLC-2.5K-20631 (5K)	5,000 lb	4 lb	6.75	1.44	1.45	3.00	.75	3.75	1.50	.10	.78	20	1.19	.67	3/4-16 UNF-2B
BLC-5K-20631 (10K)	10,000 lb	5 lb	6.75	1.94	1.69	3.00	.75	3.75	1.50	.35	.78	20	1.19	.79	3/4-16 UNF-2B

Performance

Full Scale Output
3.00 mV/V

Combidened Error
±0.03% FS

Nonlinearity
±0.03% FS

Hysteresis
±0.02%

Creep
±0.03% FS in 20 min.

Non-Repeatability
±0.01% FS

Zero Balance
±1.0% FS

Overload Safe
150% FS

Overload Ultimate
300%

Electrical

Bridge Resistance
Input 1000 ohms
output 1000 ohms

Excitation Voltage
10 VDC (15VDC max)

Insulation Resistance
5000 Mohms

Temperature

Compensated Range
-10C to +40C

Temperature Operating Range
-18C to +65C

Effect on Zero Balance
0.0015% FS/deg F

Effect on FS Output
0.0008% FS/deg F

Mechanical

Material
Stainless Steel

Sealing
IP67